

1

2

3

4

5

6

7

8

CHANGE

Revision

Date

Description

Approval

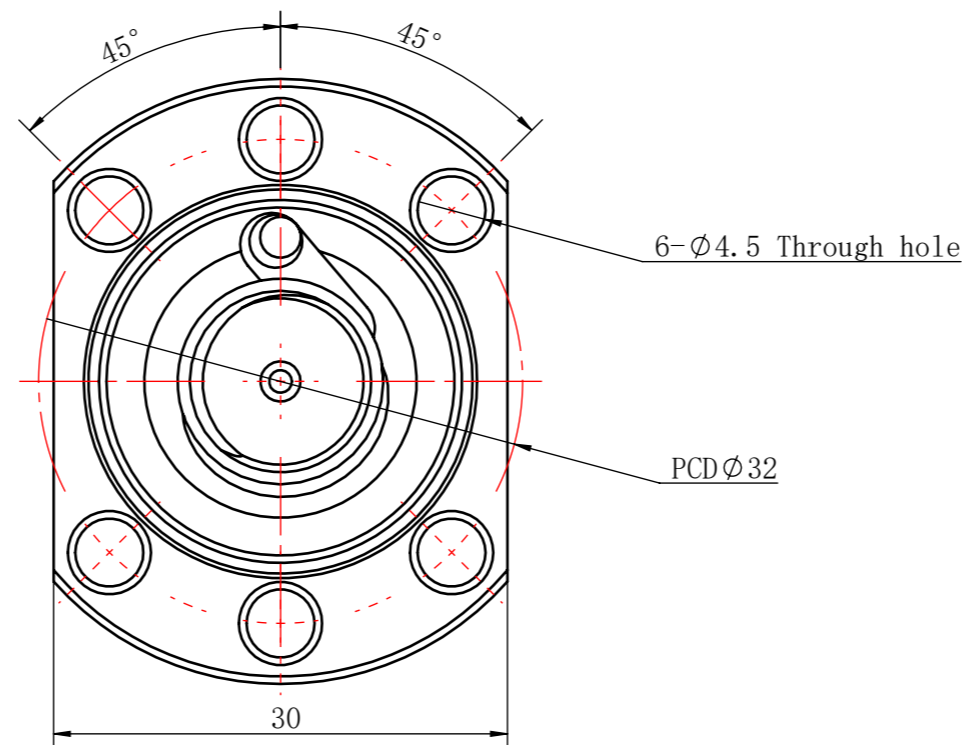
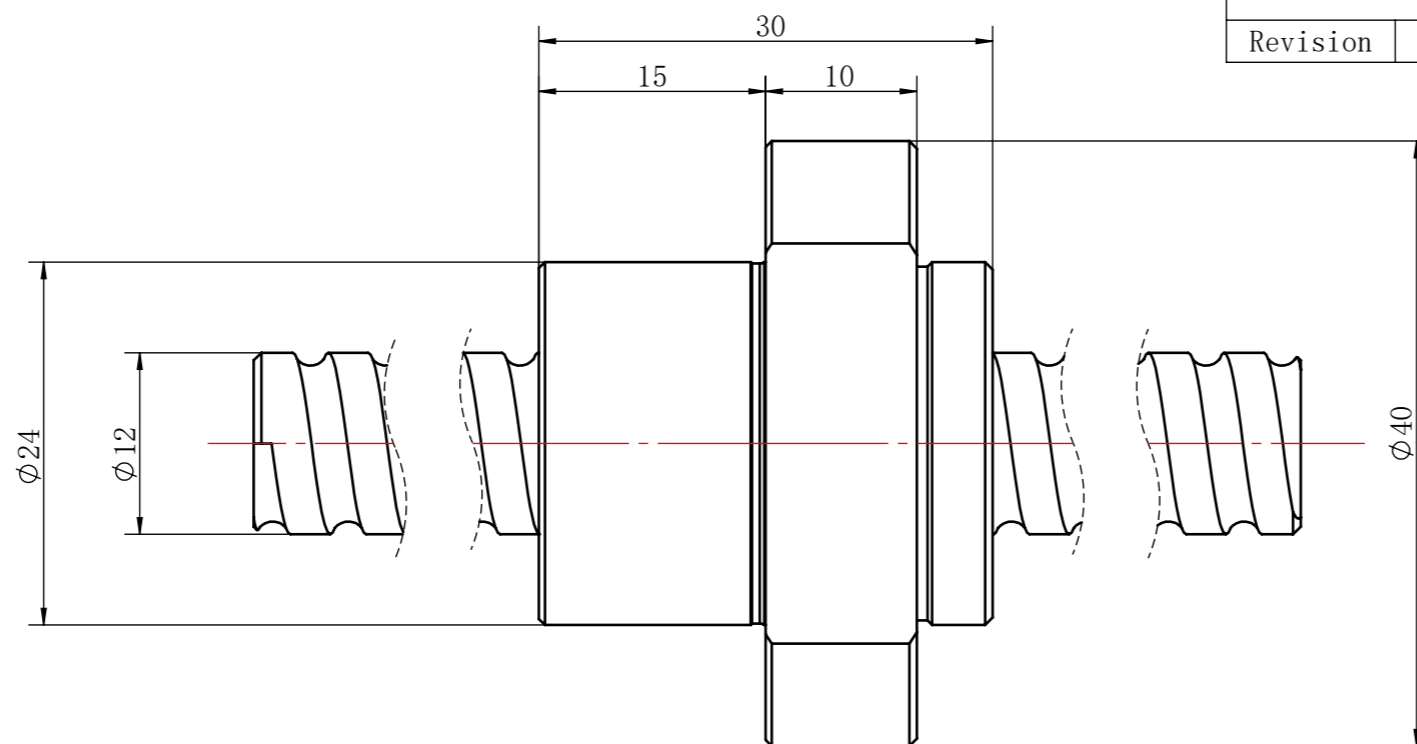

LINEAR		SPECIFICATION				CUSTOMER			
0.5~3	±0.1	B. C. D	Ø12.8	BALL SIZE	Ø2.5	C. MODLE			
>3~6	±0.1	SPACER BALL		LEAD	5	MODLE FBG1205			
>6~30	±0.2	ALLOW ROTATION NUMBER		LEAD ANGLE		NAME BALL SCREW			
>30~120	±0.3	LUBRICANT		NUMBER OF TURNSxROWS		WEIGHT			
>120~400	±0.5	O. C.	MAX. AXIAL Ca	THREAD DIRECTION/NUMBER OF THREAD		SCALE	DESIGN	REV.	
>400~1000	±0.8		MAX. RPM		DYNAMIC Ca (N)		CHECK	TOTAL:	
>1000~2000	±1.2	L. A.		T	STATIC Coa (N)	UNITS	RATIFY	PAGE:	
ANGULAR				ep	PRELORD TORQUE				
~10	±1°			Vu	AXIAL PLAY				
>10~50	±30'			V300	SCREW MATERIAL				
>50~120	±20'	V2π	NUT MATERIAL						
>120~400	±10'	ACCURACY GRADE:				JIANGSU DINGS' INTELLIGENT CONTROL			

1

2

3

4

5

6

7

8